

PART NUMBER	PART NUMBER	PART NUMBER	"A" DIAMETER	
			MAXIMUM	MINIMUM
3504	3604	3704	5/8	1/4
3506	3606	3706	25/32	7/16
3508	3608	3708	29/32	1/2
3510	3610	3710	1-1/16	9/16
3512	3612	3712	1-1/4	11/16
3516	3616	3716	1-1/2	15/16
3520	3620	3720	1-3/4	1-3/16
3524	3624	3724	2	1-7/16
3528	3628	3728	2-1/4	1-11/16
3532	3632	3732	2-1/2	1-15/16
3536	3636	3736	2-3/4	2 3/16

0360 0102 000	0360 0103 000	0360 0104 000
---------------	---------------	---------------

MATERIAL - 3500 SERIES

BAND - AISI TYPE 301 STAINLESS STEEL
HOUSING - AISI TYPE 301 STAINLESS STEEL
SCREW - AISI C1018/C1022 CARBON STEEL
CASE HARDEN
ZINC PLATE

MATERIAL - 3600 SERIES

BAND - AISI TYPE 301 STAINLESS STEEL
HOUSING - AISI TYPE 301 STAINLESS STEEL
SCREW - AISI TYPE 410 STAINLESS STEEL
HEAT TREATED
PASSIVATED

MATERIAL - 3700 SERIES

BAND - AISI TYPE 301 STAINLESS STEEL
HOUSING - AISI TYPE 301 STAINLESS STEEL
SCREW - AISI TYPE 305 STAINLESS STEEL
PASSIVATED

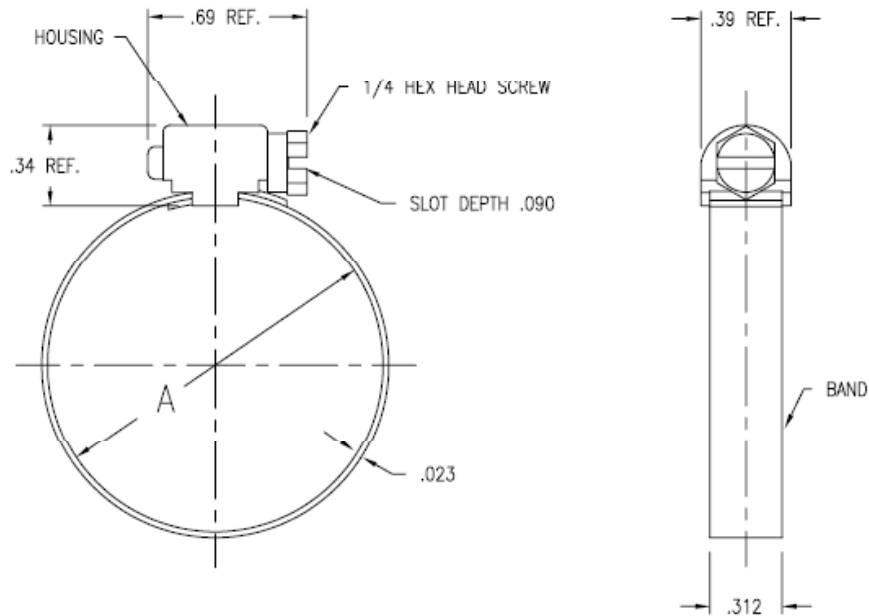

No.	REVISION	DATE	BY
2	CHANGED FRACTIONS TO DECIMALS ADDED "REF." (REF. ECR #276)	9-94	J.S.
3	ADDED SIZE 36	5/11/99	S.M.

THE INFORMATION SHOWN ON THIS DRAWING CONSTITUTES PROPRIETARY INFORMATION OF BREEZE INDUSTRIAL PRODUCTS AND MAY NOT BE COPIED IN WHOLE OR IN PART WITHOUT WRITTEN PERMISSION.

SCALE :	N.T.S.
DRAWN	3-16-93 J.S.
CHECKED	
APPROVED	

BREEZE INDUSTRIAL PRODUCTS SALTSBURG, PA. U.S.A.	
TITLE:- 3 PIECE MINIATURE CLAMP	
UNLESS NOTED, TOLERANCES ARE: .XX +/- .010 .XXX +/- .005 .XXXX +/-	FRACT. +/- 1/64 ANG. +/- 0 15'
B-8142-2	

NORMA: 0360 0102 000
0360 0103 000
0360 0104 000