

QUOTATION DRAWING

Anlieferzustand
Delivery condition

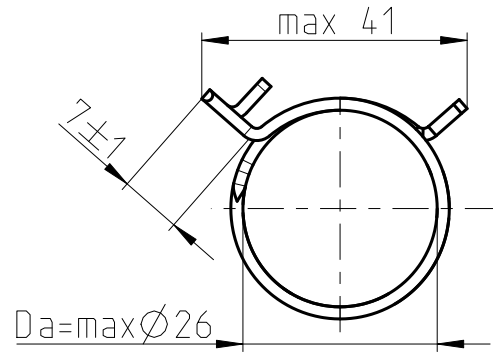

Messebene X
measure-area X

D_a :
Gemessen in Messebene X
im ungespannten Zustand
Measured in measuring plane X
in untensioned condition

Voll geöffneter Zustand
Fully opened condition

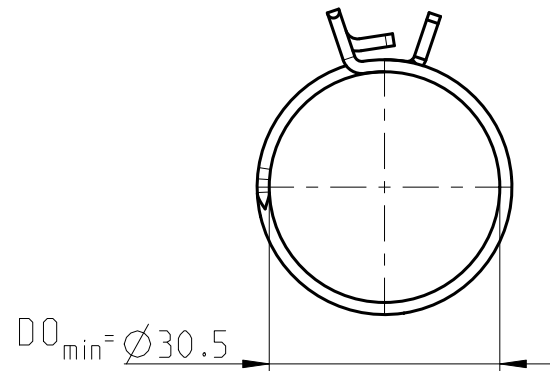

D_o :
Gespannt bis zum Anliegen
der abgewinkelten Nase;
geprüft mit Messdorn
Opened until angled nose
fits closely to ear
checked with plug gauge

Haerte = 510^{+60} HV 10
Hardness = 510^{+60} HV 10

Beschichtung:
Zink-Lamellen-Beschichtung mit organischem Topcoat
Korrosionsbeständigkeit 720 Stunden im Salzspruehtest
gemaess DIN EN ISO 9227

Coating:
Zinc-flake coating with organic Topcoat
Corrosion resistance 720h in salt spray test
acc. to DIN EN ISO 9227

| | | | | |
|----------------------|--------------------|-------------------|---------|-------------------|
| Material: | C 75 S | Weight / Volume | | |
| Material-No.: | - | Calculated: | Actual: | Volume: |
| Surface: | Basecoat / Topcoat | 11.3 g (only FBS) | - g | - cm ³ |
| GENERAL TOLERANCE: | DIN 6930-2-m | | | |
| FORM AND POS. TOL.: | DIN ISO 2768-K | | | |
| DEVIATION FOR ANGLE: | ±2° | | | |

| Teil-Nr. ITEM-NO. | Bestellnummer ORDER NO. | Index | Farbe COLOR | Farbcode COLOR CODE |
|----------------------|----------------------------|-------|------------------|------------------------|
| 1 | 0112 8074 028 | - | silber silver | - |
| 2 | 0112 8024 028 | - | schwarz black | - |
| 3 | 0112 8174 028 | - | silber silver | blau blue |
| 4 | 0112 8124 028 | - | schwarz black | grau grey |



Nenn Durchmesser DN
Nominal diameter DN

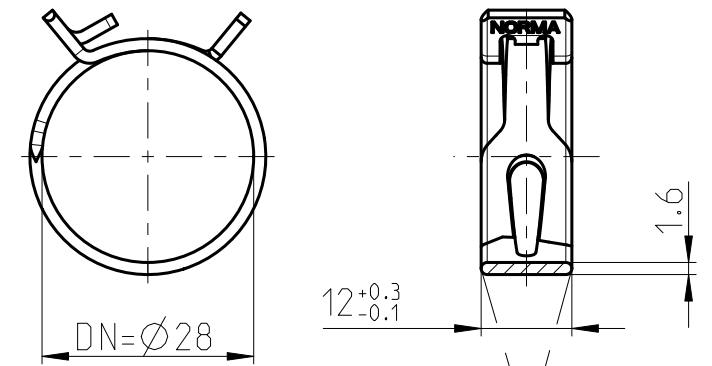

Bandkanten gerundet
band edges rounded

Zur Montage / Demontage sind die von
NORMA freigegebenen Werkzeuge zu verwenden.
Teilenummer Handzange: 0115 0000 904
Teilenummern pneumatische Zangen:
0115 0000 911; 0115 0000 912
0115 0000 919 und 0115 0000 920

Empfehlungen fuer Schlauch- und
Stutzenanforderungen nach DIN 3021-3
sind zu beachten, um funktionierendes
System zu gewaehrleisten

Recommendation for hose and spigot
requirements acc. to DIN 3021-3 have
to be considered to ensure a working
system

Assembly / disassembly is only permissible
with tools approved by NORMA.
Part number of manual pliers: 0115 0000 904
Part numbers of pneumatic tools:
0115 0000 911; 0115 0000 912
0115 0000 919 und 0115 0000 920

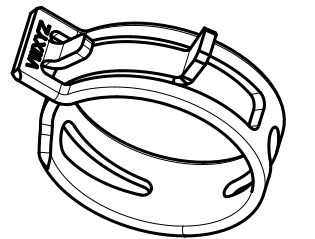

| INDEX PART | DWG | QTY | REVISION SUMMARY | | | CHANGE-NO | DATE | DRAWN | CHECKED |
|---------------|-----|-----|---|--|--|-----------|------------|------------|------------|
| - | E | 1 | Drawing updated; Table updated; Notes added; Removed views & related notes of clamp with MC & HC. | | | 01-614190 | 2017-11-29 | Tikambare | Breideband |
| - | D | - | Tolerance changed (was 25 max); notes, layout and part numbers updated | | | 01-613534 | 2016-10-31 | Lantsmann | Breideband |
| - | C | - | Drawing updated | | | 01-610330 | 2012-09-12 | Raut | Lantsmann |
| - | B | - | Drawing updated | | | 01-608076 | 2009-12-03 | Rottenbach | Wilhelm |

| | | | |
|------------------------------|--|--------------------|--------------|
| 1st ANGLE PROJECTION | ACCORDING TO: DIN EN ISO 1101 | PART NAME: | |
| | SCALE: 1:1 | FBS 28/12 | |
| | DATE: YYYY-MM-DD | acc. to DIN 3021-1 | |
| | NAME | Standard Version | |
| PROJECT-NO.: 9990001420 | NORMA Germany GmbH Postfach 1149 63461 Maintal | CUSTOMER: | CUSTOMER-NO: |
| CAD-SYSTEM: Creo 3.0 M110 | (C) COPYRIGHT NORMA GROUP DIN ISO 16016 | - | - |
| DRAWING-NAME.: 01120001028_Q | | 0112 0001 028 | |